

Sound Control Matting with Deco Pour

Read First

These suggestions represent generally accepted procedures for successful installation of Deco Pour sound control matting. These instructions may be followed, modified, or rejected by the owner, engineer, contractor or their representative since they, not Deco Pour, Inc., are responsible for planning and executing procedures appropriate to a specific application.

Installation Bulletin

Subfloor and Site Preparation

1. All preparatory site and subfloor work should be in compliance with the standards of the tile trade as well as the recommended installation procedures developed and printed by the CTI (Ceramic Tile Institute of America.)
2. Subfloor should be clean and level. Thoroughly check the subfloor, fill in any open cracks and remove any residue that would interfere with the matting. Deflection should not exceed 1/360 of the span, including expected live and dead loads.
3. If a waterproofing system is to be used, verify that the subfloor is properly sloped to the drain weep holes. Minimum recommended slope is ¼" (6.5mm) per foot. Verify that the waterproofing membrane is a load bearing membrane.

Perimeter Isolation Barrier Installation

1. Apply acoustical sealant to the lower 1" backside of the perimeter isolation barrier. The isolation barrier shall be Perimeter ISO. Perimeter isolation barrier should exceed the planned height of the floor system by 1" (2.5cm). Typically 1" to 6" (2.5 to 15.5cm) high material required.
2. Firmly press and adhere the isolation barrier to the wall or vertical partition (including door frames) surrounding the perimeter of the subfloor receiving the Deco Pour sound control system, and around the perimeter of any protrusion through the floor system, such as floor drains, columns, pipes, electrical conduits, etc.

Note: If mechanical fasteners are used for the perimeter isolation board, fasten in the top area which will be removed as excess upon completion of the floor.

Deco Pour Sound Control Installation

1. Lay the sound control matting directly over the subfloor (or waterproofing membrane if applicable) with the **black mesh down, white fabric side up**. The matting should be pushed up tightly to the isolation barrier previously installed around the perimeter of the floor.
2. Adjoining edges of the black sound control mesh must be butted together. Tape (duct tape or 2" (5cm) wide cellophane tape) the 3" longitudinal fabric overlaps snug to the fabric on the adjoining sound control matting strip. There must be no gap between adjacent sound control strips and the sound control matting must fit snugly against the perimeter isolation barrier. All seams must be taped in order to prevent any lightweight concrete from flowing into the nylon mesh and creating hard points that could compromise the acoustical isolation. Also, tape the t that is created when the sound control matting butts the perimeter isolation barrier strips.

Lightweight Concrete Installation

1. Deco Pour can be pumped directly on to the white fabric and must be a minimum of 1" (3.0cm) thick, and have a minimum 28 day compressive strength of 1800 psi. The slab should be 1000 psi (6.9 Mpa) minimum before proceeding to Step 2.
2. After Deco Pour sets up, trim the excess perimeter fiberglass board (or closed-cell foam) using a knife angled downward at a 45° to ¼" (6.5mm) below the finished tile surface. Fill the resulting groove with a bead of acoustical sealant.

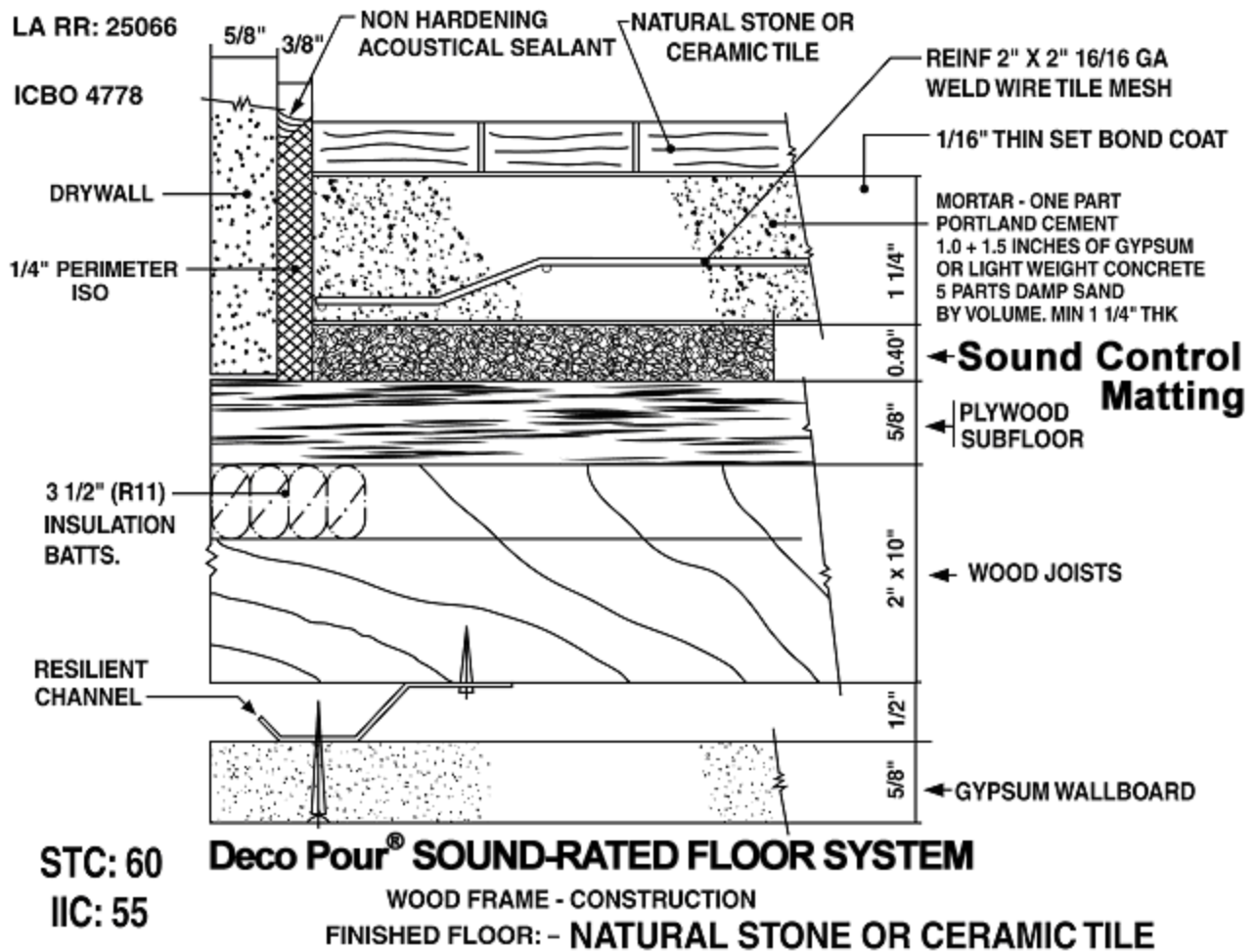

Finishing

1. **After** the finished flooring is installed, trim the perimeter isolation barrier to ¼" (6.5mm) below the finished flooring. Fill the groove with a bead of acoustical or elastomeric sealant. Do not allow hard grout to come in contact with the wall. Trim the perimeter isolation barrier flush with the surface **before** the finished flooring is installed. Shim the molding to 1/16" to 1/32" (1.6 to 0.8mm) above the finished flooring preventing a transmission path for sound between the finished floor and wall.

2. If a flat base is adhered to the wall, space it 1/8" (3mm) up from the finished flooring, and run a bead of acoustical sealant into the void. If a cove base is used, fill the joint between the last course of finished flooring and the base with acoustical sealant.

\

Warranty

IN NO EVENT SHALL DECO POUR, INC. BE LIABLE FOR CONSEQUENTIAL DAMAGES OR DAMAGES OF ANY KIND EXCEEDING THE SALE PRICE OF THE DECO POUR® SOUND CONTROL MATTING FOUND TO HAVE BEEN DEFECTIVE. DECO POUR MAKES NO WARRANTIES, EXPRESSED OR IMPLIED BY OPERATION OF LAW OR OTHERWISE INCLUDING BUT NOT LIMITED TO WARRANTIES OF MERCHANTABILITY OR FITNESS FOR ANY PARTICULAR PURPOSES OR END USE. INFORMATION CONTAINED HEREIN REGARDING APPLICATIONS OF DECO POUR SOUND CONTROL MATTING IS OF A GENERAL NATURE, AND SINCE CONDITIONS VARY WITH EACH SITE, DECO POUR MAKES NO GUARANTEE OF RESULTS OR THE SUFFICIENCY OF THE INFORMATION CONTAINED HEREIN FOR THE USE CONTEMPLATED.